

76600

Trench Drain

Medium-Duty Rectangular Specification

Josam 76600 series coated cast iron 12" x 24" rectangular medium-duty sectional trench grate.

Slot width 4-3/8" x 1/2"
(-1 & -8-2 slot width 4-3/8" x 1/2").

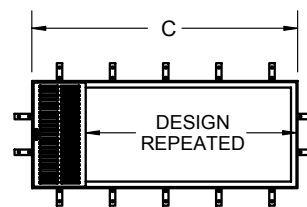
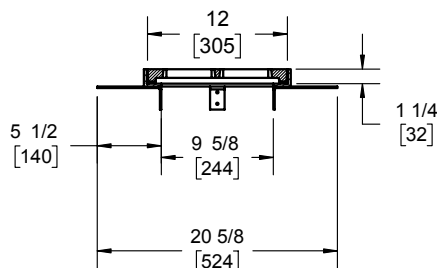
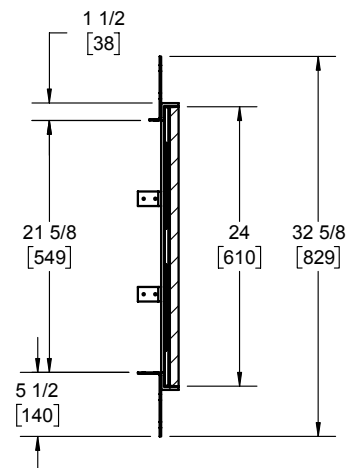
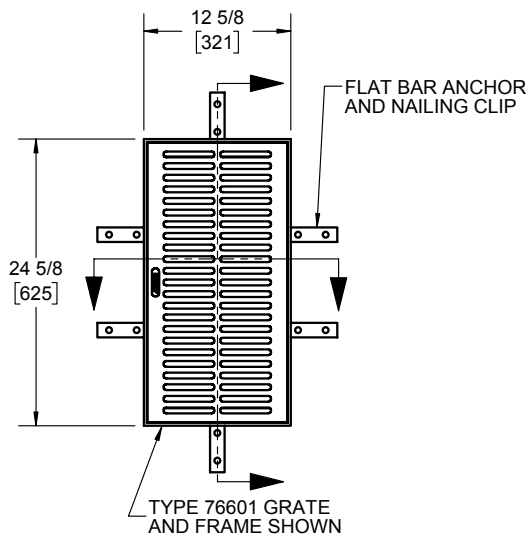
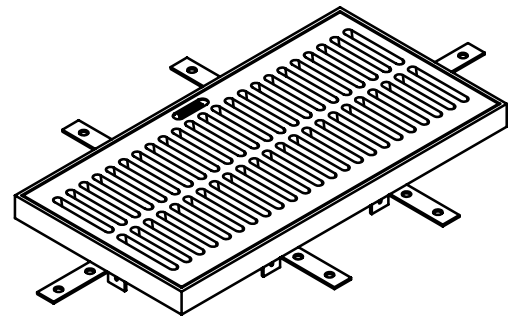

'C' = (# OF GRATES x 12") + 5/8"
INSIDE CHANNEL WIDTH = 'C' - 3"
GRATE FREE AREA (EACH) 90 SQ. IN.
GRATE ONLY DIMENSIONS = 24" x 12" x 1-1/4"
FRAME MADE OF 1-1/2" x 1-1/2" x 1/4" ANGLE

OPTIONS:

-1	Satin finish nikaloy grate, stainless steel frame
-7	Ductile iron grate
-8 -2	All bronze with satin finish top
-VP	Secured grate, vandal-proof screws
-40	Galvanized

Product is non-cancellable and non-returnable

Name: _____

Signature: _____

Date: _____

766__

(Indicate ## of grates)

Josam product specifications in U.S. customary units are approximate and provided for reference only. For precise measurements, please contact Josam Technical Support. Josam reserves the right to change or modify product design, construction, specifications, or materials without prior notice and without incurring any obligation to make such changes and modifications on Josam products previously or subsequently sold.

Notes:

